

RADI - CWR Glands for SWA Armored Cables with IP66 Rating

Radi-Gland CWR armored brass glands are designed for general-purpose application with steel wire armored PVC, XLPE and rubber sheathed cables for indoor and outdoor applications. CWR are weatherproof glands and can be used in corrosive environment when protected with shroud or heat-shrink tubing with adhesive lining. The glands are type tested and certified to BS EN 50262: 1998+A1:2001+A2:2004 and conform to BS 6121: Part 1: 1989 The products have a IP66 rating.



Technical Data:

Material

Body: Brass / nickel-plated

Seal: neoprene / nitrate rubber

Conformant standard

BS EN 50262:1998+A1: 2001

+A2: 2004, BS 6121: Part1:

1989, IP66 Rating

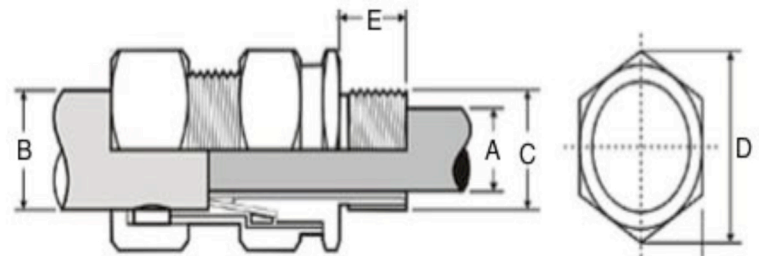

Selection Table

Part Number	Gland Size	Available Entry Thread "C"		Thread Length "E" (mm)	Overall Cable Dia. (mm) "A" (max)	Overall Cable Dia. (mm) "B"		Armor Wire O.D. (mm)	Across Corners "D" (mm) Max
		Metric	NPT			"B" (min)	"B" (max)		
RADI-CWR-16	20S/16	M20	1/2"	10	8.6	8.0	13.4	0.9	24.4
RADI-CWR-20S	20S	M20	1/2"	10	11.6	11.4	16.3	0.9 - 1.25	27.5
RADI-CWR-20L	20L	M20	1/2"	10	13.9	15.0	20.9	0.9 - 1.25	31.6
RADI-CWR-25S	25S	M25	3/4"	10	17.1	19.0	23.8	1.25 - 1.60	36.0
RADI-CWR-25L	25L	M25	3/4"	10	20.0	20.3	27.0	1.25 - 1.60	39.0
RADI-CWR-32L	32L	M32	1"	10	26.0	26.0	33.0	1.60 - 2.00	47.0
RADI-CWR-40S	40S	M40	1 1/4"	15	30.0	30.0	38.2	1.60 - 2.00	55.0
RADI-CWR-40L	40L	M40	1 1/4"	15	32.0	31.0	40.4	1.60 - 2.00	57.0
RADI-CWR-50S	50S	M50	1 1/2"	15	38.0	36.5	46.7	2.00 - 2.50	67.0
RADI-CWR-50L	50L	M50	1 1/2"	15	44.0	43.0	53.0	2.00 - 2.50	69.0
RADI-CWR-63S	63S	M63	2"	15	50.0	49.0	60.0	2.00 - 2.50	79.0
RADI-CWR-63L	63L	M63	2"	15	56.0	58.0	66.0	2.00 - 2.50	85.0
RADI-CWR-75S	75S	M75	2 1/2"	15	62.0	60.6	72.0	2.50 - 3.20	95.0
RADI-CWR-75L	75L	M75	2 1/2"	15	68.0	65.0	78.0	2.50 - 3.20	101.0
RADI-CWR-90S	90S	M90	3"	25	74.5	75.0	85.0	2.50 - 3.20	120.0
RADI-CWR-90L	90L	M90	3"	25	80.0	76.0	91.5	3.20	114.0
RADI-CWR-100	100	M100	3 1/2"	25	90.0	91.0	103.5	3.20	136.0
RADI-CWR-110	110	M110	4"	25	97.0	101.0	110.0	3.20	145.0